

## Quick Reference Guide

≈≈≈



3900 Wailea Alanui Drive, Wailea  
Maui, Hawaii 96753 US  
T: +1 808-874-8000  
F: +1 808-874-6449  
[www.fourseasons.com/maui](http://www.fourseasons.com/maui)



Kahului Airport: 35 min

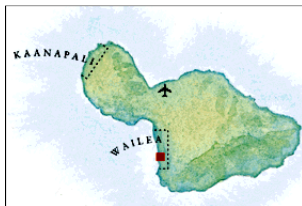

### PROPERTY

Within an enchanting enclave on Maui's most beautiful white-sand beach, Four Seasons Resort Maui at Wailea is one of the world's finest resorts. A classic Hawaiian palace, it presides over 15 oceanfront acres (6 ha) of pools, terraces and lush tropical gardens on the southwest coast, an area that enjoys the island's driest, sunniest weather.

The eight-story, classically styled resort features a glazed blue-tiled roof and is open and airy. Indoors and out flow together, with garden terraces leading into the patterned marble floors and majestic columns of the lobby.

Our ocean front property is designed in a U-shape allowing the majority of the 380 guest rooms and suites to feature incredible views of the Pacific. The Resort's magnificent facilities include an award-winning spa and health club, exquisite dining in three restaurants, enticing outdoor pools, tennis courts, a magnificent art collection, business services and extensive indoor and outdoor function spaces.

From the breathtakingly beautiful surroundings to the Resort's highly personalized and seamless service, the comfort and pleasure of our guests is ensured.

### TRANSPORTATION

Maui's Kahului Airport is a 35-minute drive away, and is served by a number of major airlines—including Alaska Airlines, American Airlines, Continental Airlines, Delta Airlines, Hawaiian Airlines, Northwest Airlines, and United Airlines—that offer flights to and from North America and major airports on the neighboring Hawaiian Islands. The Resort can arrange limousine, taxi and rental car transportation. Most major car rental companies are located at the airport and nearby offices.

### DESTINATION

The dormant peak of Haleakalā volcano and the majestic Mount Kahalawai (West Maui Mountains) tower into vivid blue skies. Upcountry ranchlands sweep down to lush forests and valleys glistening with waterfalls and brilliant with flowers. This is Maui, the most beautiful of the islands. On the southwestern coast, Wailea's white sand beaches are excellent for swimming, snorkeling, diving, whale watching and lazy strolls on the sand.

The surrounding area offers a wide range of excursions and activities:

#### ***Within 5 minutes of the Resort***

- The Shops at Wailea is a luxury resort shopping center featuring internationally renowned designers, name brand retailers, and local artisans. The diverse restaurants offer a variety of dining options and price points in an open-air environment.

#### ***Within 30 minutes of the Resort***

- Iao Valley is a tropical rain forest featuring lush green botanical garden pathways. It is also the site of the famous 2,000 ft. (610 m<sup>2</sup>) lava rock pinnacle, "Iao Needle", and is a great area for picnics.
- The Maui Tropical Plantation hosts 60 acres (49 ha) of Hawaii's famous fruits, crops and flowers. The guided tram provides a narrated tour of the agricultural farming of Maui's sugar cane, macadamia nuts, bananas, pineapples and papayas. Learn how to make flower leis and weave palm fronds into baskets.
- The Maui Ocean Center is a journey of discovery through the extraordinary underwater world of the living reef, to the open ocean. You will encounter living coral, fishes, and plant-life. The Center is the only facility in the world dedicated to fostering understanding, wonder and respect for Hawaii's marine life—one of the most unique aquatic environments on earth.
- The Alexander & Baldwin Sugar Museum was previously a sugar plantation superintendent's residence. Exhibits explain the process of growing sugar cane and producing sugar in the factory. Photo murals and artifacts depict life in a sugar plantation community and the people and events that created Hawaii's predominant industry for nearly a century.
- The site of the Maui Historical Society was built in the 1830s as the home of missionary Edward Bailey. It contains Hawaiian artifacts from times before western contact and furniture and household items from the missionary days.

**Within 60 minutes of the Resort**

- Pa'ia, a coastal plantation town with a cultural heritage shaped by the sugar industry with a rural ambience. It is a lively mix of clothing stores, curio shops and restaurants.
- Ho'okipa Beach, windsurfing capital of the world, is the first choice and the greatest challenge for windsurfing's best. Here, experts carve and "shred" perfect wave after wave, and conditions allow for record-breaking aerial maneuvers and unsurpassed heights in wave jumping.
- One of the state's last cowboy (*paniolo*) towns, Makawao is surrounded by rolling hills and horse ranches. Specialties of the area include unique art galleries, eateries and small shops selling everything from world-famous cream puffs to paniolo gear.
- Lahaina town, once a major whaling port, has maintained steep roots in the historic culture of old Hawaii coupled with a variety of restaurants and curio shops. Also known as the art capital of the Pacific with more art galleries per capita than any other American town.

**Within 3 hours of the Resort**

- The drive to Hana encompasses 617 curves and crosses 56 one-lane bridges. Sites include lava sea cliffs, tropical rain forests, spectacular waterfalls, and the pools at Oheo Gulch. Take the opportunity to enjoy a picnic lunch, swim or hike any one of the main trails.
- Enjoy a sunrise tour of Mount Haleakalā. Rising 10,000 feet (3,000 m<sup>2</sup>), it is renowned for its raw beauty and unique scenery. The world's largest dormant volcano, its crater is large enough to hold Manhattan. Mark Twain called it the "sublimest" spectacle he had ever witnessed.

**CLIMATE**

Owing to its southwest coastal location, Wailea is noted for having the sunniest and driest climate on Maui. Average annual rainfall is less than 11" (28 cm).

Month	Highs		Lows	
January	81°F	27°C	70°F	21°C
February	80	26	69	20
March	81	27	70	21
April	82	28	71	21
May	82	28	72	22
June	83	28	74	23
July	84	29	75	24
August	87	30	77	25
September	86	30	76	24
October	84	29	75	24
November	82	28	73	23
December	81	27	71	21

**ACCOMMODATIONS**

Perched on the golden crescent of Wailea Beach and bathed in year-round sunshine, Four Seasons Resort Maui welcomes you to Hawaii as you've always imagined it. The Resort offers 383 luxury accommodations, including 75 suites, all featuring hardwood floors, thoughtful design touches, Maui's most spacious resort bathrooms, customizable Four Seasons beds and the "My Bar" concept, which includes a Nespresso machine and a range of customizable drink options all day long. With meticulously designed interiors that reflect a modern Hawaiian aesthetic, each guest room and suite provides a quiet hideaway in the midst of this legendary, world-leading Resort.

**STANDARD ROOMS**

Our Standard Rooms comprise the largest guest rooms on Maui, which means you can enjoy contemporary luxury with round-the-clock Four Seasons care in total comfort. Each of our Standard Rooms features a cozy sitting area and a private lanai with views of the Pacific, our manicured garden or Mount Haleakala in the distance.

**Ocean-View Prime Room**

When repeat guests return to Four Seasons Resort Maui at Wailea, they know to choose one of these ocean-view rooms, which offer the best of all worlds. Out the large windows and from the lanai, stunning Pacific vistas combine with panoramic views of our formal sculpture garden and reflecting pools, while inside, the meticulous design and thoughtful amenities create a quiet, private hideaway.

**Ocean-View Prime Room**

When repeat guests return to Four Seasons Resort Maui at Wailea, they know to choose one of these ocean-view rooms, which offer the best of all worlds. Out the large windows and from the lanai, stunning Pacific vistas combine with panoramic views of our formal sculpture garden and reflecting pools, while inside, the meticulous design and thoughtful amenities create a quiet, private hideaway.

**Partial Ocean-View Room**

Soak in the tranquility watching the Pacific in the distance from the comfort of a private, oversized lanai in one of these entry-level rooms. This is a great choice for guests who pine for a Pacific view at the best value.

**Partial Ocean-View Room**

Soak in the tranquility watching the Pacific in the distance from the comfort of a private, oversized lanai in one of these entry-level rooms. This is a great choice for guests who pine for a Pacific view at the best value.

**Garden-View Room**

Featuring oversized lanais that provide up-close views of our lush tropical gardens, these rooms are airy havens of calm.

**Mountain-Side Room**

Spend your days on Maui exploring the island before coming home to one of these thoughtfully designed rooms, which provide the full Four Seasons Resort Maui experience at the best value. These rooms overlook a small parking area, with Mount Haleakala in the background.

**SMALL SUITES**

Our Small Suites allow for a wide range of residential comforts, including a living room for additional leisure and entertainment space, a 65-inch ultra-high-definition LED TV, a multipurpose dining table, a separate bedroom with spacious bathroom as well as expanded closet space.

**Ocean-View Prime Four Seasons Executive Suite**

With exceptional views of the Pacific, our formal sculpture garden and reflecting pools, these suites invite you to gaze out the large windows or drink in the vistas from the lanai. The interiors are equally inviting and feature an intuitive, clean design that maximizes space and comfort. These are among the most popular suites among repeat guests at Four Seasons Resort Maui at Wailea, as they offer easy access to our recreation facilities and are ideal for longer stays and family vacations.

**Ocean-View Prime Four Seasons Executive Suite**

With exceptional views of the Pacific, our formal sculpture garden and reflecting pools, these suites invite you to gaze out the large windows or drink in the vistas from the lanai. The interiors are equally inviting and feature an intuitive, clean design that maximizes space and comfort. These are among the most popular suites among repeat guests at Four Seasons Resort Maui at Wailea, as they offer easy access to our

recreation facilities and are ideal for longer stays and family vacations.

**Ocean-View Four Seasons Executive Suite**

For small families or couples seeking space and privacy, these suites offer an intelligent layout that maximizes space and possibilities. Intuitively designed interiors – from smart shelving units to strategically located power outlets – create an enhanced living experience, while views of the neighboring Wailea resort community and angled views of the Pacific from the lanai remind you that yes, you're in paradise.

**Garden-View Four Seasons Executive Suite**

Ideal for families vacationing to Maui, these entry-level Maui hotel suites provide better value than paying for two rooms. Extra touches, like the lanai that affords views of the neighboring Wailea resort community and our beautifully manicured Hawaiian gardens, help create a transformative Maui experience.

**LARGE SUITES**

Offering total comfort and privacy, our Large Suites feature a full-sized bedroom connected to the spacious living and dining area by a solid plantation-style door. For maximum convenience, each suite has one full bathroom and an additional three-quarter bathroom with shower. Expansive outdoor lanais beckon you outside to relish the ocean or garden view, and thoughtful design touches invite you back inside to relax and unwind in peace. Some of these suites can be expanded into a two-bedroom configuration to allow for greater flexibility.

**Ocean-View Prime Suite**

With cleanly designed interiors and views spanning the ocean and the Resort's formal

sculpture garden and reflecting pools, these large, versatile one- or two-bedroom suites perfectly combine form and function for an enhanced the guest experience. A multipurpose table, for instance, can be used for dining or as a work station, and a dresser is integrated into the nook area adjacent to the master bathroom to free up space in the main room and hold garments in the most convenient place for changing.

**Garden-View Suite**

Overlooking our beautifully manicured tropical gardens, these suites are smartly designed to create a comfortable and inviting living space, and they also incorporate thoughtful features, such as docking stations for digital tablets on the nightstand, resulting in an enhanced guest experience.

**RESIDENTIAL SUITES**

Our Residential Suites are available in one- or two-bedroom configurations, or they can even be connected internally with an adjoining suite to create a three- or four-bedroom configuration. Any configuration you choose allows you to experience Maui in all its pristine glory, with elevated, sweeping views of the ocean, the beach and neighboring islands from the living room, bedroom and expansive outdoor lanai. For total peace and quiet, make yourself at home and enjoy a drink from the expanded bar set-up, or curl up in the suite's entertainment zone, which features a 75-inch 4D TV. Whatever your choice, our Residential Suites offer enhanced privacy and security as well as a host of thoughtful touches to put you completely at ease.

**Ocean-Front Prime Suite**

The inspired design of the suite's interior incorporates Hawaiian artwork and evocative textures and patterns to create a comfortable retreat that is unmistakably Maui. The living and dining areas are physically separated for privacy, and an extra bathroom provides convenience and comfort.

**PRESIDENTIAL SUITES**

Our Presidential Suites – the most exclusive suite category – comprise two suites with three bedrooms and three suites with two bedrooms featuring different layouts and designs. These residential-style suites each have enhanced privacy and security, an entertainment zone with 75-inch 4D TVs, large pantry areas, imaginative bar set-ups, a unique wine collection and curated contemporary Hawaiian art collections. The luxury extends to the pool with a complimentary cabana.

**Elite Ocean-Front Suite**

Directly facing the beach and offering stunning ocean views, these residential-style two-bedroom suites offer abundant living, working and entertaining space, including a sit-down wet bar area. These can also be combined with an adjoining suite to create a three-bedroom configuration, with all configurations featuring oceanfront views. Dine or lounge on the expansive lanai that extends the entire width of each suite, or enjoy a moment of quietude in any one of its comfortable nooks and crannies

**Lokelani Presidential Suite**

Among Maui's most magnificent accommodations, this three-bedroom presidential suite offers 6,800 square feet (632 square metres) of indoor and outdoor

living space, plus a 5,000-square-foot (465-square-metre) private garden on the ground level. Lokelani means "heavenly rose," and the garden features many of these small, fragrant flowers. This Maui three-bedroom suite features teak hardwood floors and contemporary residential design, highlighted by a collection of original Hawaiian art and a Sonos sound system.

The small pantry area is ideal as a set-up area for staff serving cocktails or meals.

With awe-inspiring ocean front views of the Pacific and neighboring islands, this is the ultimate Hawaiian vacation home with every luxury thoughtfully included by Four Seasons Resort Maui at Wailea.

**Maile Presidential Suite**

Located on the penthouse floor directly facing the ocean, this 4,750 square-foot (441-square-metre) Maui three-bedroom royal suite is appropriately named. Maile is a fragrant native plant traditionally used to create beautiful lei for royalty and other people of significance. Our best Maui hotel suite, the expansive living areas – equipped with a Sonos sound system – open to the equivalent of six individual lanais, connecting across the front of the suite and providing different settings for lounging and dining. The small pantry area is convenient for staff serving cocktails or meals. The suite's three bedrooms each include a lavish bathroom and extra closet space. This residential-style three-bedroom suite provides an unparalleled experience at Four Seasons Resort Maui at Wailea.

Unsurpassed on the Island. Works by local artists have been specially commissioned to accent the décor. Bedrooms and living spaces feature large flat-screen, high-definition TVs and high-speed digital wiring that allows for wireless connectivity. Guests

enjoy comfortable seating, a large marble bathroom and a spacious, furnished lanai.

The Four Seasons Resort Maui is an eight-story, classically styled building with a U-shaped design. A vast majority of rooms and suites are afforded dazzling views of the Pacific Ocean, while others overlook the tropical hillsides of Mount Haleakalā and landscaped gardens.

***Guest Rooms***

Spacious at 600 sq. ft. (56- m<sup>2</sup>), all guest rooms feature a large conversation area with either a king bed or two queen beds and a large private lānai. Full marble master bathroom includes double sink basins, deep soaking tub and separate seamless shower.

**Ilima Hospitality Room**

This one-of-a-kind elegant room is ideal for entertaining. With a distinctive décor and designer furnishings, it measures 1,130 sq. ft. This room offers a generous living room with a dining area that seats eight, a private bar, a large bathroom with shower facilities, and a small pantry accessible from the corridor. The garden lanai is ringed with palm trees.



**Guest Room**

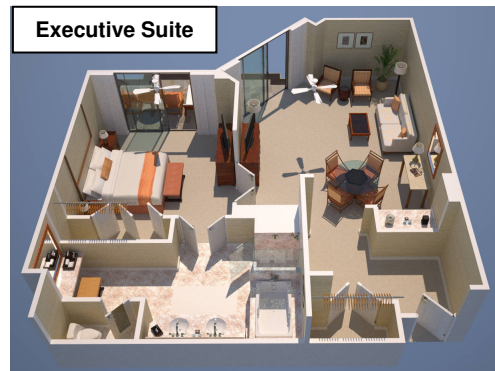

**Executive Suite**



**One-Bedroom Suite**



**Two-Bedroom Suite**



**Ocean Front Elite  
Three-Bedroom Suite**



**Lokelani  
Three-Bedroom Suite**



**Maile Suite**

Guest Room Inventory		
Room Category	Size	
	(sq. ft.)	(m <sup>2</sup> )
Guest Rooms		
Mountain Side	600	56
Garden View	600	56
Partial Ocean View	600	56
Ocean View	600	56
Ocean View Prime	600	56
Club Floor Ocean View	600	56
Four Seasons Executive Suites		
Garden View	830-850	77-79
Ocean View Prime	830-850	77-79
Club Floor Ocean View Prime	830-850	77-79
One-Bedroom Suites		
Garden View	1,000	93
Ocean View Prime	1,400	130
Ocean Front Prime	1,400	130
Club Floor Ocean Front Prime	1,400	130
Two / Three / Four-Bedroom Suites		
Ocean View Prime (Two-Bedrooms)	2,000	186
Ocean Front Prime (Two-Bedrooms)	2,000	186
Ocean Front Prime (Three-Bedrooms)	2,600	242
Ocean Front Prime (Four-Bedrooms)	4,000	372
Elite Ocean Front (Two-Bedrooms)	2,600	223
Lokelani Suite (three-bedroom)	4,400	167
Maile Suite (three-bedroom)	4,750	450

## IN-ROOM / SUITE AMENITIES

- All bedding is hypo-allergenic
- Oversized 100 percent cotton terry bath towels
- Soft microfiber bathrobes or cotton Yukata robes
- Terry slippers
- Blankets of 100% cotton available
- Choice of feather or hypo-non-allergenic foam pillows available
- Full-size hairdryer (retractable)
- Bathroom scale available upon request
- Shampoo, conditioner and after sun balm, shower cream and body lotion
- Hypo-non-allergenic bath soap available upon request
- Cotton swabs/balls, make-up pads, shower caps; sewing kit upon request
- Lighted make-up/shaving mirrors, lint brush, shoehorn
- Hangers: slack/skirt, wooden and satin
- Luggage racks
- Samsung™ 65" HD television
- Mini Dell Pad™
- All-news cable network
- Individual temperature control
- Air conditioning and ceiling fans
- GuestTek (in-room television system)
- Smoke detectors
- Personal safe
- Mini-refrigerators stocked to order
- Individual "emergency" items (i.e., toothbrush, toothpaste, deodorant, mouthwash, razors, shaving cream) upon request
- Emergency flashlight
- Nespresso coffee/tea service
- Data port on telephone, two-line phones
- Wireless Internet access (daily charge)
- Iron/board/Woolite
- Swimsuit rack for drying hand washed items, upon request
- Separate shower and extra deep tub/ and dual sinks
- Twice daily maid service
- Complimentary shoe shine service
- Bottled water
- Daily newspaper available upon request

## COMPLIMENTARY GUEST SERVICES AND FACILITIES

The **only** resort on Maui that does **not** charge a resort fee

- Traditional *lei* greeting, *oshibori* towels and a chilled beverage upon arrival
- Specially equipped rooms for physically challenged (ADA compliant)
- Twice-daily housekeeping service with evening turndown and ice delivery
- Overnight shoeshine
- Standard WiFi in guest rooms, business center, and public areas
- Coffee and tea service from 2:00 a.m. – 6:00 a.m. in the Lobby
- Coffee and tea service from 5:30 a.m. – 10:00 a.m. in the Games Room
- In-room Nespresso coffee machine and capsules
- In-room coffee machine with Hawaiian Kona coffee (upon request)
- In-room tea service: hot water boiling pot, teapot, assorted teas, lemon, honey and mugs (upon request)
- In-room bottled water for two daily
- In-room safe
- In-room stereo
- DVD players on request
- DVD library
- Children's program, *Kids for All Seasons*, (ages 5-12 years) open daily from 9 a.m. to 5 p.m. (nominal fee for lunch)
- Children's amenities including a welcome gift, as well as use of toys, games, videos and books
- Infant needs: cribs, strollers, high chairs, playpens and safety attachments

- Ice water, iced towels and Evian spritz service at the pools and beach
- Food amenity served at pool and beach four times a day
- Three pools (40' x 80' heated saline pool, with fountain in center, a free-form lagoon pool with waterfall and slide as well as an adjacent shallow children's pool, and a 120' long infinity-edge design Serenity Pool with two bubble loungers and an underwater music system. The Serenity Pool is an "adults only" environment – minimum age requirement is 21 years)
- Pool cabanas and beach umbrellas (Serenity Pool Luxury Cabanas at a fee)
- Kindle reading devices with self-guided resort art tour for loan at the Concierge Desk
- Two whirlpools at the main Fountain Pool and Serenity Pool
- Hawaiian outrigger canoe paddling program Monday through Friday on Wailea Beach (weather permitting and advance reservations required)
- Snorkel equipment (one hour use daily)
- Introductory SCUBA clinics twice daily
- Fitness classes daily
- Exercise attire and sneakers available on loan through The Spa
- Twenty-four hour open-air Cardio and air-conditioned Weight Room with Matrix Strength Machines, free weights, treadmills, elliptical ascent trainers, step mills, upright and recumbent bikes
- The Spa's private locker rooms with showers, steam room, amenities available from 6 a.m. to 9 p.m.
- Two lighted Nova'Pro sand-filled synthetic grass tennis courts – racquets and balls provided
- Golf putting green – putter rentals and golf balls available at the Bell Desk
- Croquet lawn and equipment, Bocce Ball

- Games Room open 6 a.m. to 11 p.m. daily with table shuffleboard, foosball, ping pong, billiards, big screen TV, video games (including Wii™, Xbox 360 and PlayStations) and board games.
- Resort car to golf, tennis, shopping, and restaurants in the Wailea area
  - Aloha Suite for early arrivals and late departures

## FOOD & BEVERAGE / CATERING

Hawaiian cuisine is an epicurean adventure with its myriad of cultural influences, and nowhere are the island specialties and fresh delights as superbly prepared and impeccably served as at Four Seasons Resort Maui at Wailea. At your request, chefs can provide delicious healthy gourmet selections.

## RESTAURANTS

### DUO Steak & Seafood

A multiple award-winning restaurant, guests are encouraged to dine "DUO" style for breakfast and dinner at this culinary jewel. Offering a wide array of brunch items, guests have the option of enjoying the delectable "Wailea" or "Full Island" buffets or an American style breakfast. For dinner, DUO transforms into a premium steak and seafood restaurant with a robust menu of perfectly aged prime cuts of steak and the freshest of island seafood and seasonal produce—complemented by a distinctive collection of over 200 premium international wines.

Seats 162 Private Dining Room 36

### Ferraro's Bar e Ristorante

The spectacular beachfront setting of Ferraro's is enhanced by its open-air design. An ideal spot for relaxed lunches or cocktails at the sunset bar. The diverse menu showcases the fresh seafood and produce of Hawaii, including salads, sandwiches, tropical juices and drinks, with a full bar selection. At night, guests dine under the stars and enjoy authentic Italian cuisine prepared *cucina rustica* style. A *kiawe*

wood-burning oven produces flavorful flatbread pizzas. A wide range of delicacies, including tantalizing seafoods, fish and pasta are featured nightly. Live dinner music blends with the gentle breeze and the sounds of the sea.

Seats 130

### Spago

Master Chef Wolfgang Puck's menu fuses Hawaiian and California cuisine with Pacific Rim flavors, utilizing the finest and freshest local ingredients and some traditional island cooking techniques. Designed with a contemporary approach to Asian design, this premiere restaurant features a stunning bar area allowing guests to enjoy the magnificent panoramic views of the Pacific Ocean and the West Maui Mountains. A unique drink menu features wines from around the world, at varied price points.

Seats 130

Private Dining Room 90

### Lobby Lounge

The open air Lobby Lounge is an oasis of hospitality and relaxation overlooking the formal pool, surrounding gardens and the sparkling blue Pacific. An innovative pūpū menu features local delicacies. Live entertainment is offered in the evenings.

## Food and Beverage Hours of Operation

<b>DUO</b>	
Breakfast	6:00 am — 11:30 am
Dinner	6:00 pm — 9:00 pm
<b>Ferraro's</b>	
Bar Service	11:00 am — 9:00 pm
Lunch	11:30 am — 4:00 pm
Dinner	6:00 pm — 9:00 pm
<b>Spago</b>	
Dinner	6:00 pm — 10:00 pm
<b>Lobby Lounge</b>	
Cocktails	5:00 pm — 11:30 pm
Hours fluctuate seasonally with daylight	



## CONFERENCE AND BANQUET FACILITIES

With over 25,000 sq. ft. (2,359-m<sup>2</sup>) of meeting and function space, all opening to sunny terraces and ocean views, the Resort easily accommodates gatherings from 10 to 750 people.

The elegant 6,930 sq. ft. (644-m<sup>2</sup>) Four Seasons Resort Ballroom (divisible into two rooms) is the choice for receptions of up to 750 and banquets for up to 500.

The Ballroom Foyer adds 2,474 sq. ft. (225-m<sup>2</sup>) of space with dramatic ocean views. This open-air reception area is centrally located and can be adapted to meet individual needs.

Two junior ballrooms are designed for functions of up to 150 and are fully adaptable to guests' choice of seating or presentation arrangements. Five conference rooms come complete with permanent screen and microphone outlets. The 840 sq. ft. (78-m<sup>2</sup>) Ali'i boardroom is an ocean front setting fit for high-level meetings.

The 5,200 sq. ft. (484-m<sup>2</sup>) Ocean Front Lawn accommodates up to 500 guests complete with a permanent stage and production capabilities. The Ali'i Lawn is 3,100 sq. ft. (248-m<sup>2</sup>) and allows for receptions at sunset. The Fountain View Lawn and adjacent Terrace are ideal for intimate dinner settings of up to 60 people.

- Video cameras, video projectors, video players
- Microphones, mixers, amplifiers
- Audio CD/DVD players
- Stands, carts, easels, flipcharts, laser pointer, speaker timer
- On-site technician
- Wired or wireless high-speed Internet access packaged to accommodate individual needs

## TECHNICAL ASSISTANCE

From basic to complex, our onsite provider, PSAV, continually strives to provide the most technically advanced equipment. We encourage groups to turn to Swank to deliver the spectacular for "outside the box" production needs.

- Lecterns with light and sound control
- PC presentation, overhead projectors, LCD projectors
- Multi-image dissolve units and programmers
- Built-in screens and drape kits



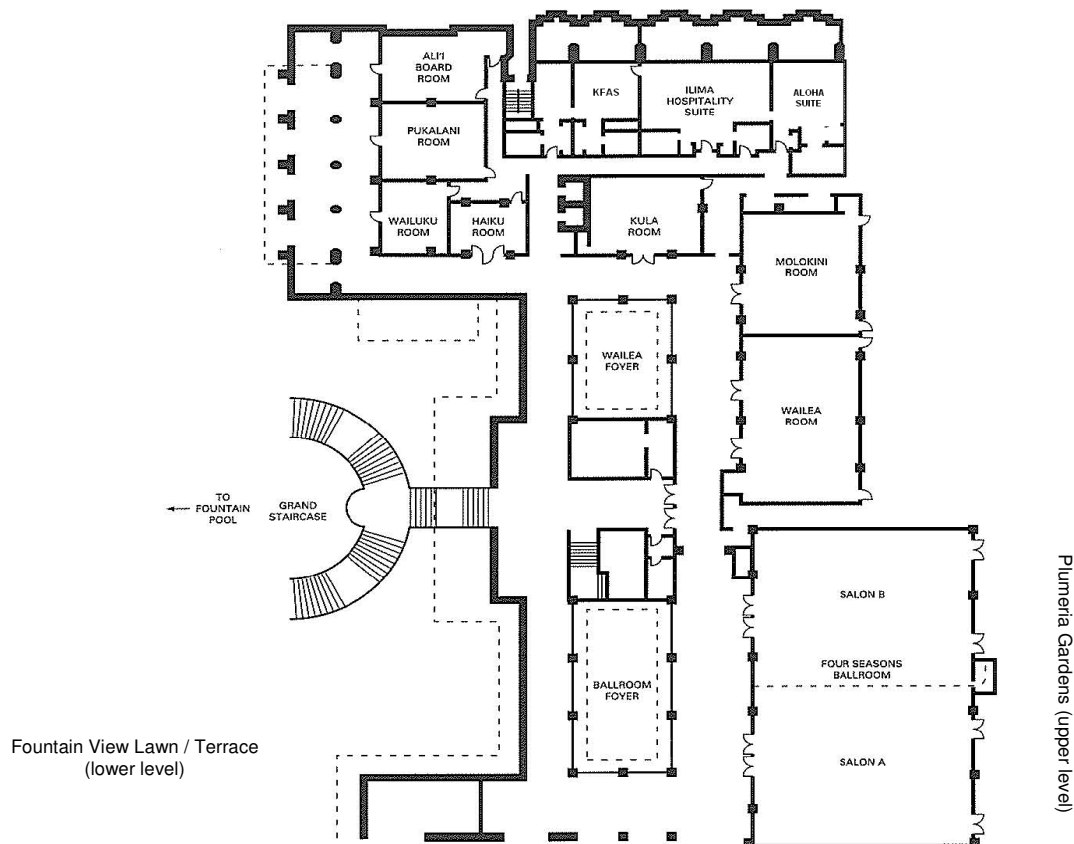

Room	Dimensions (ft.)	Size		Ht. (ft.)	CAPACITIES						
		(sq. ft.)	(m <sup>2</sup> )		Reception	Banquet	Theatre	Class- room	Conference	Hollow Square	U- Shape
Four Seasons Ballroom*	66' x 105'	6,930	644	13'	750	500	700	380	—	108	—
Salon A	50' x 66'	3,300	322	13'	375	225	350	190	20	72	54
Salon B	50' x 66'	3,300	322	13'	375	225	350	190	20	72	54
Ballroom Foyer	60' x 27'	1,620	150	—	500	110	—	—	—	—	—
Wailea Room	36' x 56'	2,016	184	12'	150	120	176	96	20	46	42
Wailea Foyer	27' x 38'	1,026	95	—	120	50	—	—	—	—	—
Molokini Room	35'6" x 40'	1,420	132	12'	120	70	128	72	20	42	33
Kula Room	24'6" x 32'6"	796	74	11'	75	50	70	45	20	30	24
Haiku Room	15'6" x 23'6"	364	34	11'	27	20	24	9	16	—	15
Wailuku Room	19' x 24'	456	42	11'6"	45	30	28	18	16	18	15
Pukalani Room	16'6" x 30'	495	46	11'6"	45	30	40	24	20	18	15
Ali'i Room	28' x 30'	840	78	11'6"	75	40	50	36	20	24	20
Ali'i Lawn**	29' x 45'	1,305	104	—	60	40	—	—	—	—	—
Ilima Hospitality ***	38'5" x 19'8"	864	80	11'4"	20	—	—	—	10	—	—
Ocean Front Lawn	Irregular	5,200	484	—	500	480	600	—	—	—	—
Fountain View Lawn	Irregular	3,100	288	—	100	80	—	—	—	—	—
Fountain View Terrace	16 x 59'	944	87	12'	60	60	—	—	—	—	—
Sunset Lawn	Irregular	1,275	388	—	100	70	—	—	—	—	—
Beachfront	Irregular	598	185	—	75	50	—	—	—	—	—
Plumeria Garden**	Irregular	1,500	139	—	60	—	—	—	—	—	—
Wailea Point	Irregular	387	118	—	50	30	—	—	—	—	—
Beachfront Lawn	Irregular	598	182	—	75	50	—	—	—	—	—

\* Ballroom: divisible in two (Salon A and Salon B) 1 ft. = 0.3048m

\*\* Ali'i Lawn and Plumeria Garden: 7:00 pm curfew. All other outdoor venues have 10:00 pm curfew.

\*\*\*Ilima Suite: 864 sq. ft. (80-m<sup>2</sup>) interior space plus 439 sq. ft. (41-m<sup>2</sup>) lānai (not a guest room)

All space capacities do not include for stages, dance floor, buffets, audio/visual equipment, etc.

1 sq. ft. = 0.0929 m<sup>2</sup>

## Electrical Outlets

The guest rooms are equipped with 110 volt outlets. Function rooms voltage capacity ranges from a single 20 amp wall outlet to a 480 volt 3 phase distribution panel.

### MUSIC AND ENTERTAINMENT

Conference Services managers will be happy to assist with setting up any type of music or entertainment for your meeting.

## RECEIVING / MAINTENANCE

### Receiving

The Resort offers full-service shipping and receiving. All packages should be sent to the attention of the group's name and Conference Service manager. Limited space is available for the storage of large items. Please time shipping to the date of your arrival.

### Receiving Dock

Please contact your Conference Services manager to discuss delivery arrangements for oversized packages or environmentally sensitive equipment.

### Maintenance

The Engineering Department is available 24-hours a day for general assistance with lighting, room temperature control and minor repairs.

## BUSINESS FACILITIES

The following business services are available:

- 24-hour services (photocopying, fax, mail and postage, delivery)
- Airline ticketing service
- Typing/secretarial services
- Translation services
- DVD rental
- Personal computers
- International newspapers, periodicals

## SPOUSE PROGRAMS

Your Conference Service manager can assist with activities to interest spouses of meeting participants:

- Fashion show and lunch
- Hawaiian monarchy show
- White-on-White croquet tournament
- Organized shopping excursions
- Whale watching/champagne cruise
- Scenic tour of upcountry Maui
- Cooking class or demonstration
- Winery tour

## CHILDREN'S AND FAMILY PROGRAMS

The Resort offers Kids for All Seasons, a complimentary program for children aged 5-12 years. Professionally organized activities are fun and educational, with an emphasis on contemporary and traditional Hawaiian arts, crafts and games. Upon check-in, children receive a personal invitation to participate in Kids for All Seasons.

Reservations are recommended.

The Resort provides a variety of items at no charge, including child-sized bathrobes, cribs and rollaway beds, bottles, toys and baby toiletries. Children's menus are available in Resort restaurants and through in-room dining. Babysitting services may be arranged.

Teen programs are also offered. The Games Room is complimentary and is equipped with pool tables, ping-pong tables, foosball, state-of-the-art electronic games and a large flat screen TV.

## ART COLLECTION

The Resort has amassed a never-before-attempted collection of contemporary Hawaiian fine art installed in the public areas and guest rooms. The collection encompasses works from Hawaii's statehood in 1959 to present day. The goal was to create a visually captivating experience throughout the property by weaving together

the story told by this "next generation" of artists working, living or born in Hawaii and which reflects Hawaii's rich palette and textures, while evoking the energy of the land and sea in a bold style.

## RECREATIONAL FACILITIES (On-Site)

### ***Beach and Pools***

Four Seasons Resort Maui is located ocean front on Wailea Beach, which is recognized as one of Maui's finest beaches. The lava formations to the north and south enhance the beach's crescent shape and reach out to protect the pristine white sand, while creating an underwater ecosystem ideal for snorkeling. Guests are invited to enjoy swimming and water sports.

The Resort offers two heated outdoor swimming pools. Overlooking the ocean, the 40 x 80 ft (12x24-m<sup>2</sup>) Fountain Pool has a whirlpool at each end and a central fountain. Close to the beach, the lagoon pool features a naturalistic waterfall. The small slide and shallow wading pool are perfect for children.

Food and beverage service are available poolside. Attendants provide complimentary provide ice water, chilled towels, Evian water spritz, and snacks twice daily.

The Spa offers demi-treatments from the comfort of your lounge chair.

### ***The Spa***

Combines a sleek, modern design with ancient and traditional treatment offerings (21,000 sq. ft). The Spa is a nurturing retreat, which includes 13 indoor treatment rooms and three ocean-side thatched *hales* (huts), encouraging guests to relax, revitalize and renew. The Spa's highly skilled staff of therapists is trained to perform Traditional Hawaiian, Master Thai, Craniosacral and Ayurvedic applications.

### ***The Salon***

The Salon is located on the lower lobby level and offers a variety of beauty treatments, including hairstyling, manicures and pedicures.

### ***Fitness Center***

Located within The Spa, the fitness area is generously furnished with all the latest fitness and training equipment. The temperature-controlled room enables guests to work out in comfort 24-hours per day and is enhanced by floor-to-ceiling mirrors on three walls. Guests also enjoy the adjacent canopied open-air outdoor cardiovascular area. Certified personal trainers are available on request to help guests get the most out of their workout. A variety of fitness classes—including yoga, Pilates and tai chi—are offered, accompanied by complimentary fruit juices, water and chilled towels. The club's state-of-the-art facilities include:

- Weight circuit facility
- Cardiovascular equipment that includes treadmills, ellipticals, stair climbers and rowing machines
- Aerobics room

### ***Tennis***

The Resort features two lighted Omni, sand-filled synthetic grass courts. Complimentary racquets, ball machines and balls are provided. Our staff of Peter Burwash International (PBI) professionals are available for lessons and clinics daily.

### ***Water Equipment Rental***

Snorkels and masks are provided by the hotel daily. Surfboards, sailboards, underwater cameras, kayaks and paddle boards skis may be rented through our on-site vendor.

### ***SCUBA Diving***

In addition to complimentary pool clinics, the following activities are available daily:

- Introductory reef dive
- Off-site dive (Makena Landing or Ulua Beach)
- Boat dive: Two-tank Molokini and Turtle Pinnacles, including all necessary equipment.
- SCUBA Week Certification: boat dive, scooter dive, night dive and unlimited beach dives.
- PADI SCUBA Certification: Includes four ocean dives, all equipment and materials kit
- Night dive (certified divers only)
- Underwater scooter

### ***Other***

The Resort offers a complimentary putting green and croquet course.

Also available to guests, upon request, at no charge: volleyball, ping pong, Frisbees, flotation jackets, and beach balls.

## **RECREATIONAL FACILITIES**

### ***Off-Site***

A wide variety of recreational delights are available close to the Resort.

### ***Sailing***

Equipment and lessons are available out of Ma'a'lea and Lahaina harbors

### ***Golf***

Four Seasons Resort Maui is unique in that it offers eight outstanding golf experiences all within a two- to 30-minute drive of the Resort. The most popular Wailea resort courses include:

- The 7,070-yard Wailea Gold Course is Wailea's claim to golfing fame. Designed by Robert Trent Jones II, it won accolades from *Golf Magazine* as one of the top 10 places to play. Taking advantage of a 200-ft (61-m<sup>2</sup>) elevation change, the Gold Course offers breathtaking ocean and mountain views that have inspired the phrase "visual hazards." The modern design

incorporates many of the best elements from golf courses around the world.

- Stretching 6,825 yards from the back tees, the Wailea Emerald Course offers a magnificent tropical look and exciting layout created to be fun for golfers at all levels. The Emerald Course offers spectacular views of Mount Haleakalā and the Pacific Ocean. Players will find a double green shared by the 10<sup>th</sup> and 17<sup>th</sup> holes, fronted by a lake and lush gardens of brilliant blooms.
- Wailea Golf Club is the site of the first David Leadbetter Golf Academy in Hawaii. Recognized as one of the leading golf instructors in the world, David Leadbetter is often associated with his contribution to the successes of Nick Faldo, and continues to work with such leading golfers as Nick Price, Ernie Els, Justin Rose, Charles Howell III, Sean O'Hair, Tevor Immelman and Hawaii's own Michelle Wie.

### ***Tennis***

In addition to the tennis facilities at the Four Seasons Resort, Maui's largest tennis facility—and Hawaii's most complete—The Wailea Tennis Center is located within minutes of the hotel. Facilities include 11 hard-surface plexi-pave courts, a half-court for practice, lessons by resident pros, and fully stocked pro shop featuring fashionable tennis wear and top-of-the-line equipment. Among the hard courts is a stadium court with grassy terraces capable of accommodating up to 1,000 fans.

### ***Other Recreational Activities***

- Helicopter tours
- Sailing charters
- Sport fishing
- Horseback riding
- Hiking tours
- Kayak adventures
- Bicycle tours
- Snorkel cruises
- Shopping excursions

